



relinea®

PRODUCT & SERVICE INFORMATION

GRP Riserguard

relinea.com

All-in-one GRP RiserGuard Solution

Relinea's GRP RiserGuard is an all-in-one system designed to help you fill a void quickly & effectively, crucially ensuring on-site safety for construction workers. Our riser flooring system is manufactured entirely using Glass Reinforced Plastic (GRP) structural components in combination with mesh grating offering a number of benefits over existing products on the market.

Combining our excellent products & services with the benefits of GRP allows us to offer our customers the best possible solution for their project.

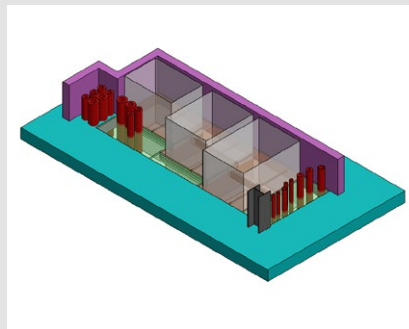

Fully Designed GRP RiserGuard System Solution from start to finish

Cost Certainty	<ul style="list-style-type: none"> ✓ A flexible & practical solution which removes the challenges of riser flooring installation, reducing overall costs. ✓ Eliminates the need for costly edge protection thus avoiding continuous inspection & surveillance. ✓ Reduces the cost of installation of M&E equipment by providing easy lift out panels. ✓ Reduces the need for return visits to site by other trades.
Safer Solution	<ul style="list-style-type: none"> ✓ Provision of a fully floored out riser void at the outset eliminates the risks of falls. ✓ Reduces the risk posed during the M&E installation by providing a safe working platform. ✓ Eliminates the need for hot works and permits on site. ✓ Lightweight components that are easily handled and installed.
Cleverly designed	<ul style="list-style-type: none"> ✓ Innovative use of sustainable GRP structural materials that are prefabricated into individually packaged kits. ✓ The design incorporates the full M&E layout using fully supported lightweight lift out panels. ✓ CAD drawings that can be incorporated into BIM models. ✓ Specifically designed solutions to suit a variety of flooring arrangements.
Performance	<ul style="list-style-type: none"> ✓ High strength to weight ratio. ✓ Impact resistant. ✓ Ultra-slip resistant. ✓ Non-conductive & non-sparking. ✓ Fire resistant.
Lower installation cost	<ul style="list-style-type: none"> ✓ RiserGuard can be installed at any stage during the construction of a building – ‘the earlier the better’. ✓ Flexible design combined with lightweight, easily fabricated material allows for straightforward on-site modification. ✓ Reduced safety requirements for M&E contractors reducing their costs. ✓ Avoids the need for specialist trades returning to site.
Improved on-site handling	<ul style="list-style-type: none"> ✓ Individual Pre-packaged Kits that are prefabricated to suit each riser can be easily transported around the site. ✓ Lightweight components can be manually handled into position, eliminating the need for heavy lifting equipment. ✓ Reduces health & safety risks associated with lifting out complete areas and having to reinstall remedial support beams.

Standards, Environment and Quality

RiserGuard can be designed to meet load up to 7.5kN/m² and we work to all the relevant standards including:

- BS 4592-0:2006+A1:2012 Parts 0,4,5 & 6 Industrial Type Flooring
- BS EN 13706 2002 Reinforced plastics composites. Specifications for pultruded profiles
- BS EN ISO 14122 Parts 1 & 2 Safety of machinery. Permanent means of access to machinery.

As standard, our Grating meets Class 1 under BS476 but we can also offer a full systems to meet BS EN13501 B1-S1-Do.

Our products are manufactured under the Environmental standard BS 8555 and ISO 9001:2015 Quality System.

Glass Reinforced Plastic (GRP) Vs Steel (Flowforge)

	GRP	Steel (Flowforge)
Strength	Excellent strength to weight ratio. Impact resistant, will not permanently deform from impact.	Heavy to achieve its high strength properties. Can permanently deform under impact.
Weight	Up to 80% lighter than steel. Can be manually handled around site.	Requires heavy lifting equipment to move & place.
Maintenance Free	Does not rust or corrode. Zero maintenance requirements even in aggressive environments.	Will oxidise & corrode if exposed to the elements. Requires constant maintenance.
Sustainability	Low life cycle costs with a design life of over 50 years. Resource friendly manufacturing.	High life cycle costs and limited design life. Steel production is very energy intensive.
Anti-Slip	GRP grating offers exceptional slip resistance properties even in wet or oily conditions.	Steel flooring offers very limited anti-slip properties.
Non-Sparking	No requirement for Hot Works Permits.	Hot Works Permits required.
Conductivity	Non-conductive. No earthing required.	Conducts electricity. Earthing required.
Fabrication	Easily fabricated using simple power tools.	Requires trained personnel and hot works.
Cost	Lower installation costs. Can be easily altered on site. Considerable cost savings to other trades.	Material pricing can be unstable. Higher installation costs. Higher alteration costs.



RiserGuard Technical Information

Relinea offer 2 types of GRP RiserGuard, each unique to your project. The complete all in-one M&E Package and our Standard Package for riser void protection.

GRP RiserGuard M&E Package

Relinea’s advanced RiserGuard M&E Package is designed around the M&E services. Providing a full structural support system with easily handled lift out panels.

Stage 1: M&E Layout

Using the latest CAD software, we incorporate the M&E layout for accurate positioning of structural supports and flooring.

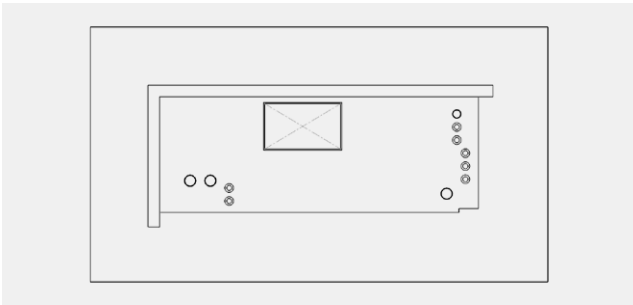

Stage 2: Support Installation

GRP 'Re-Struct' profiles are installed into the riser void with specifically designed bracketry and certified fixings.

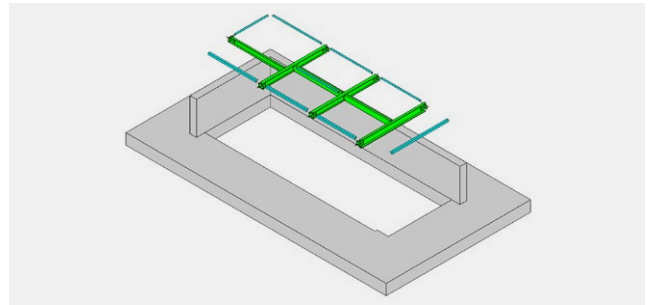

Stage 3: Flooring Installation

GRP 'Re-Grid' bi-directional grating is securely fixed to structural framework with lightweight lift out panels to suit the M&E layout.

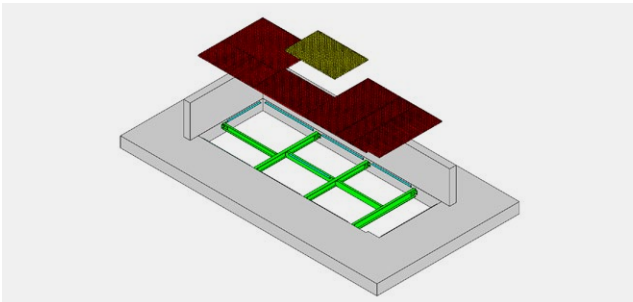

Stage 4: Completed RiserGuard Installation

The void has now been filled ensuring site safety for all personnel.

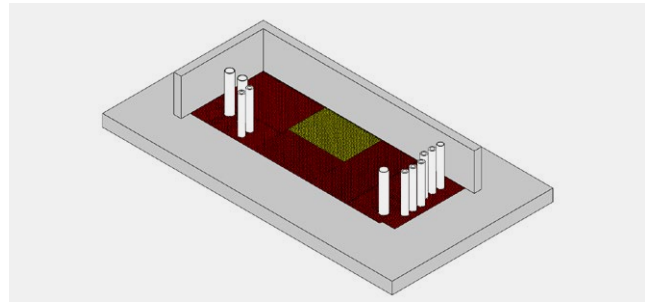

Stage 5: Pipework Installation

Sections can be cored on site using standard cutting tools, to allow for the passage of pipes through the grating.

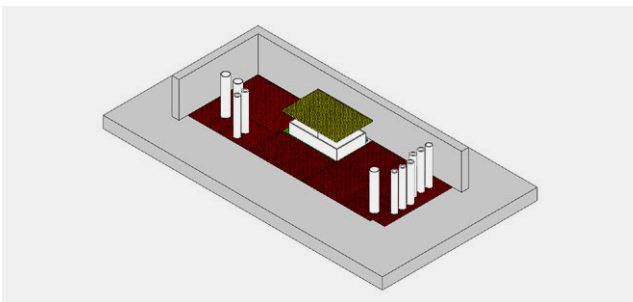

Stage 6: Duct Installation

Lightweight lift out panels allow ducts to easily pass through the grating whilst providing a safe working platform.

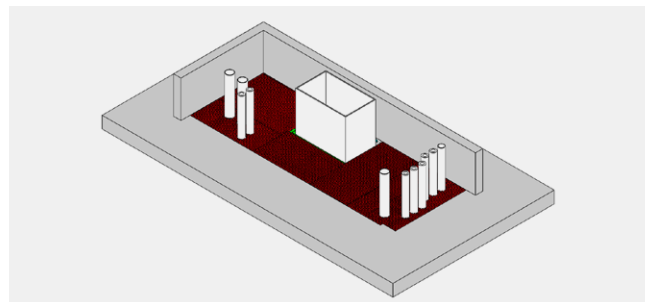

RiserGuard Technical Information

Standard RiserGuard Service Package

Our standard RiserGuard package* is a cost-effective solution designed to help you fill the void quickly and effectively.

Stage 1: Shelf Angle Installation

Re-Struct GRP shelf angle installed around the perimeter of the riser void as required.

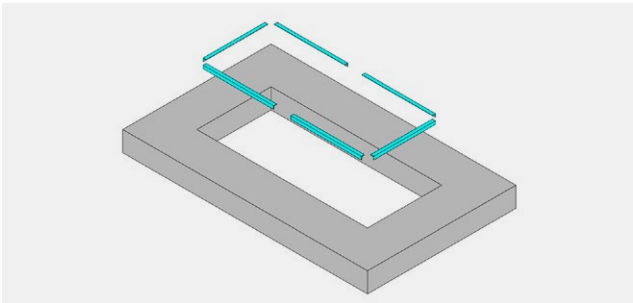

Stage 2: Additional Support Installation

For wide riser voids additional support beams maybe required to adequately support the grating.

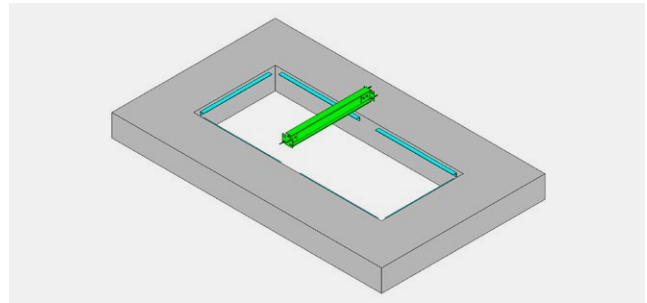

Stage 3: Flooring Installation

GRP 'Re-Grid' bi-directional grating is securely fixed to structural framework.

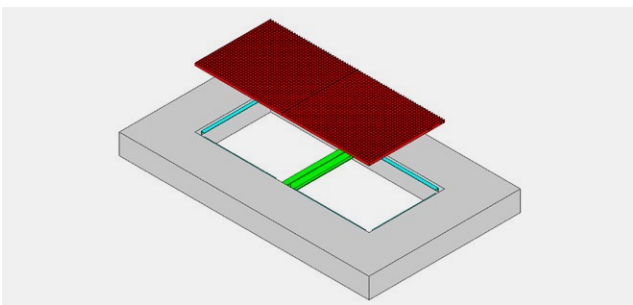

Stage 4: Completed Installation

The void has now been filled ensuring site safety for all personnel.

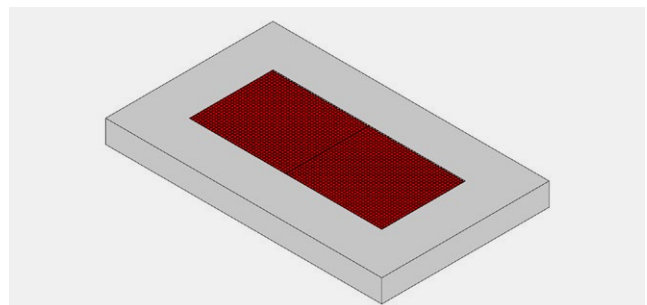

* Our Standard RiserGuard Package is designed only to fill the riser void and avoids the need for on-site fall protection and associated policing.

Additional supports would be required to support grating around the M&E services.

The Standard RiserGuard Package tends to be used when the M&E package has not been decided.

Relinea Service 6 Step Approach

Let us manage your project & requirements from initial consultation to completed on-site installation using our 6-step approach.



Free initial consultation & project review

Expert advice & product knowledge backed up with years of experience working with glass reinforced plastic (GRP) products across multiple industries. Benefit from a free project review & quotation today!



On-site surveys carried out by our specialist team

Accurate & detailed site surveys carried out by our dedicated team who operate throughout the UK & Ireland. Have peace of mind that your site has been correctly surveyed helping to ease product installation.



Full design capabilities using our expert engineers

With one of the largest and most experienced design team's in our sector, specifically tasked to provide cost-effective and technically innovative fibreglass solutions using the latest CAD technology and BIM modelling, we aim to save cost and ensure ease of installation.



Complete in-house fabrication & delivery to site

In-house fabrication using our specialist fabrication team. With a focus on offsite modular built units, to reduce site installation time. Significant stock holding this enables us to provide a fast & efficient turnaround.



Fully qualified & skilled installation

Installation using our fully trained & qualified team who operate throughout the UK & Ireland. Installation is completed to the highest of standards with thorough post installation checks.



Continued aftersales support.

We will continue to support you once installation is completed. Our team of experts are on hand to answer any further questions or queries you may have surrounding our range of products & services.

Other GRP Solutions for you!

GRP Plant Decking



Emergency Disabled Roof Access Ramp



GRP Platforms



GRP Rooftop Platforms

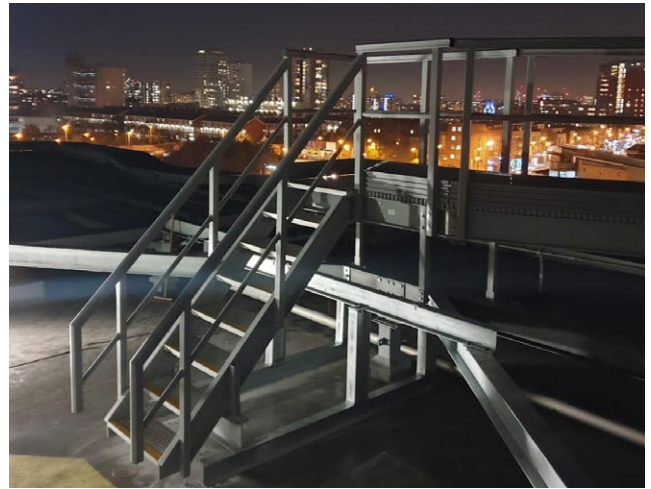

GRP Ladders

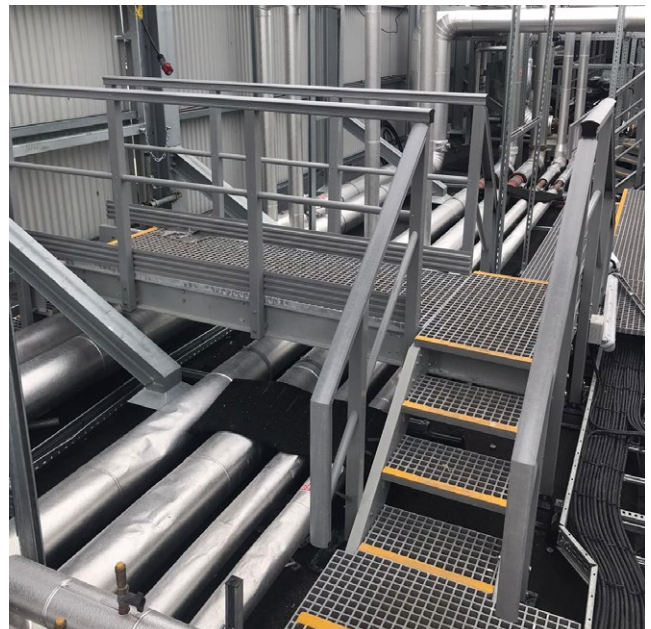





We are a trusted pioneering expert in GRP with over 15 years' experience working across multiple industries. More than just suppliers, we offer an advanced range of products and services to best support your project.

To further support your project, we can also offer the following additional services:

- Detailed design calculations using a trusted & reputable structural engineer
 - Anchor pull out testing, carried out by a fully qualified construction fixings association (CFA) approved tester
 - FEA analysis which can be backed up with live load & impact testing.
-

relinea[®]
Reliable, Resourceful.

Relinea
14 Crosshill Road
Crumlin BT29 4BQ
N. Ireland

T +44 (0) 28 9447 0010
E info@relinea.com

relinea.com